

# xEffect - Industrial Switchgear Range Miniature Circuit Breakers FAZT



Catalog



Powering Business Worldwide

SG56012



## Description

### FAZ-T

- High-quality miniature circuit breakers for industrial and commercial applications
- Contact position indicator red - green
- Accessories suitable for subsequent installation
- Rated currents up to 40 A
- Tripping characteristics B, C, D
- Rated breaking capacity up to 25 kA according to EN 60947-2
- Classified for the use in rail rolling stock

| Rated current<br>$I_n$ (A) | Rated voltage<br>acc. to<br>IEC/EN<br>60898-1<br>(V) | Breaking<br>capacity<br>acc. to<br>IEC/EN<br>60898-1<br>(kA) | Rated voltage<br>acc. to<br>IEC/EN<br>60947-2<br>(V) | Breaking<br>capacity<br>acc. to<br>IEC/EN<br>60947-2<br>(kA) | Rated voltage<br>acc. to<br>IEC/EN<br>60947-2<br>(V) | Breaking<br>capacity<br>acc. to<br>IEC/EN<br>60947-2<br>(kA) | Type<br>Designation | Article No. | Units per<br>package |
|----------------------------|--|--|--|--|--|--|---------------------|-------------|----------------------|
|----------------------------|--|--|--|--|--|--|---------------------|-------------|----------------------|

**Characteristic B**

SG53212



**1-pole**

|    |     |    |     |    |     |    |            |        |        |
|----|-----|----|-----|----|-----|----|------------|--------|--------|
| 1  | 240 | 15 | 240 | 25 | 254 | 15 | FAZT-B1/1  | 240770 | 12/120 |
| 2  | 240 | 15 | 240 | 25 | 254 | 15 | FAZT-B2/1  | 240771 | 12/120 |
| 3  | 240 | 15 | 240 | 25 | 254 | 15 | FAZT-B3/1  | 240772 | 12/120 |
| 4  | 240 | 15 | 240 | 25 | 254 | 15 | FAZT-B4/1  | 240777 | 12/120 |
| 6  | 240 | 15 | 240 | 25 | 254 | 15 | FAZT-B6/1  | 240782 | 12/120 |
| 10 | 240 | 15 | 240 | 25 | 254 | 15 | FAZT-B10/1 | 240787 | 12/120 |
| 12 | 240 | 15 | 240 | 25 | 254 | 15 | FAZT-B12/1 | 240792 | 12/120 |
| 13 | 240 | 15 | 240 | 25 | 254 | 15 | FAZT-B13/1 | 240793 | 12/120 |
| 15 | 240 | 15 | 240 | 25 | 254 | 15 | FAZT-B15/1 | 240794 | 12/120 |
| 16 | 240 | 15 | 240 | 25 | 254 | 15 | FAZT-B16/1 | 240795 | 12/120 |
| 20 | 240 | 15 | 240 | 25 | 254 | 15 | FAZT-B20/1 | 240796 | 12/120 |
| 25 | 240 | 15 | 240 | 25 | 254 | 15 | FAZT-B25/1 | 240797 | 12/120 |
| 32 | 240 | 10 | 240 | 20 | 254 | 15 | FAZT-B32/1 | 141907 | 12/120 |
| 40 | 240 | 10 | 240 | 20 | 254 | 15 | FAZT-B40/1 | 141908 | 12/120 |

SG5412



**1+N-poles**

|    |     |    |     |    |     |    |             |        |      |
|----|-----|----|-----|----|-----|----|-------------|--------|------|
| 1  | 240 | 15 | 240 | 25 | 254 | 15 | FAZT-B1/1N  | 240994 | 1/60 |
| 2  | 240 | 15 | 240 | 25 | 254 | 15 | FAZT-B2/1N  | 240995 | 1/60 |
| 3  | 240 | 15 | 240 | 25 | 254 | 15 | FAZT-B3/1N  | 240996 | 1/60 |
| 4  | 240 | 15 | 240 | 25 | 254 | 15 | FAZT-B4/1N  | 240997 | 1/60 |
| 6  | 240 | 15 | 240 | 25 | 254 | 15 | FAZT-B6/1N  | 240998 | 1/60 |
| 10 | 240 | 15 | 240 | 25 | 254 | 15 | FAZT-B10/1N | 240999 | 1/60 |
| 12 | 240 | 15 | 240 | 25 | 254 | 15 | FAZT-B12/1N | 241000 | 1/60 |
| 13 | 240 | 15 | 240 | 25 | 254 | 15 | FAZT-B13/1N | 241001 | 1/60 |
| 15 | 240 | 15 | 240 | 25 | 254 | 15 | FAZT-B15/1N | 241005 | 1/60 |
| 16 | 240 | 15 | 240 | 25 | 254 | 15 | FAZT-B16/1N | 241009 | 1/60 |
| 20 | 240 | 15 | 240 | 25 | 254 | 15 | FAZT-B20/1N | 241015 | 1/60 |
| 25 | 240 | 15 | 240 | 25 | 254 | 15 | FAZT-B25/1N | 241019 | 1/60 |
| 32 | 240 | 10 | 240 | 20 | 254 | 15 | FAZT-B32/1N | 142509 | 1/60 |
| 40 | 240 | 10 | 240 | 20 | 254 | 15 | FAZT-B40/1N | 142510 | 1/60 |

SG55212



**2-poles**

|    |     |    |         |    |         |    |            |        |      |
|----|-----|----|---------|----|---------|----|------------|--------|------|
| 1  | 415 | 15 | 240/415 | 25 | 254/440 | 15 | FAZT-B1/2  | 240820 | 1/60 |
| 2  | 415 | 15 | 240/415 | 25 | 254/440 | 15 | FAZT-B2/2  | 240821 | 1/60 |
| 3  | 415 | 15 | 240/415 | 25 | 254/440 | 15 | FAZT-B3/2  | 240822 | 1/60 |
| 4  | 415 | 15 | 240/415 | 25 | 254/440 | 15 | FAZT-B4/2  | 240823 | 1/60 |
| 6  | 415 | 15 | 240/415 | 25 | 254/440 | 15 | FAZT-B6/2  | 240824 | 1/60 |
| 10 | 415 | 15 | 240/415 | 25 | 254/440 | 15 | FAZT-B10/2 | 240825 | 1/60 |
| 12 | 415 | 15 | 240/415 | 25 | 254/440 | 15 | FAZT-B12/2 | 240826 | 1/60 |
| 13 | 415 | 15 | 240/415 | 25 | 254/440 | 15 | FAZT-B13/2 | 240827 | 1/60 |
| 15 | 415 | 15 | 240/415 | 25 | 254/440 | 15 | FAZT-B15/2 | 240828 | 1/60 |
| 16 | 415 | 15 | 240/415 | 25 | 254/440 | 15 | FAZT-B16/2 | 240829 | 1/60 |
| 20 | 415 | 15 | 240/415 | 25 | 254/440 | 15 | FAZT-B20/2 | 240830 | 1/60 |
| 25 | 415 | 15 | 240/415 | 25 | 254/440 | 15 | FAZT-B25/2 | 240831 | 1/60 |
| 32 | 415 | 10 | 240/415 | 20 | 254/440 | 15 | FAZT-B32/2 | 142485 | 1/60 |
| 40 | 415 | 10 | 240/415 | 20 | 254/440 | 15 | FAZT-B40/2 | 142486 | 1/60 |

# 1.3

## Miniature Circuit Breakers

xEffect

### FAZ-T Miniature Circuit Breakers

| Rated current<br>$I_n$ (A) | Rated voltage<br>acc. to<br>IEC/EN<br>60898-1<br>(V) | Breaking<br>capacity<br>acc. to<br>IEC/EN<br>60898-1<br>(kA) | Rated voltage<br>acc. to<br>IEC/EN<br>60947-2<br>(V) | Breaking<br>capacity<br>acc. to<br>IEC/EN<br>60947-2<br>(kA) | Rated voltage<br>acc. to<br>IEC/EN<br>60947-2<br>(V) | Breaking<br>capacity<br>acc. to<br>IEC/EN<br>60947-2<br>(kA) | Type<br>Designation | Article No. | Units per<br>package |
|----------------------------|--|--|--|--|--|--|---------------------|-------------|----------------------|
|----------------------------|--|--|--|--|--|--|---------------------|-------------|----------------------|

SG53512



#### 3-poles

|    |     |    |         |    |         |    |            |        |      |
|----|-----|----|---------|----|---------|----|------------|--------|------|
| 1  | 415 | 15 | 240/415 | 25 | 254/440 | 15 | FAZT-B1/3  | 240874 | 1/40 |
| 2  | 415 | 15 | 240/415 | 25 | 254/440 | 15 | FAZT-B2/3  | 240875 | 1/40 |
| 3  | 415 | 15 | 240/415 | 25 | 254/440 | 15 | FAZT-B3/3  | 240876 | 1/40 |
| 4  | 415 | 15 | 240/415 | 25 | 254/440 | 15 | FAZT-B4/3  | 240877 | 1/40 |
| 6  | 415 | 15 | 240/415 | 25 | 254/440 | 15 | FAZT-B6/3  | 240878 | 1/40 |
| 10 | 415 | 15 | 240/415 | 25 | 254/440 | 15 | FAZT-B10/3 | 240879 | 1/40 |
| 12 | 415 | 15 | 240/415 | 25 | 254/440 | 15 | FAZT-B12/3 | 240880 | 1/40 |
| 13 | 415 | 15 | 240/415 | 25 | 254/440 | 15 | FAZT-B13/3 | 240881 | 1/40 |
| 15 | 415 | 15 | 240/415 | 25 | 254/440 | 15 | FAZT-B15/3 | 240882 | 1/40 |
| 16 | 415 | 15 | 240/415 | 25 | 254/440 | 15 | FAZT-B16/3 | 240883 | 1/40 |
| 20 | 415 | 15 | 240/415 | 25 | 254/440 | 15 | FAZT-B20/3 | 240884 | 1/40 |
| 25 | 415 | 15 | 240/415 | 25 | 254/440 | 15 | FAZT-B25/3 | 240885 | 1/40 |
| 32 | 415 | 10 | 240/415 | 20 | 254/440 | 15 | FAZT-B32/3 | 142493 | 1/40 |
| 40 | 415 | 10 | 240/415 | 20 | 254/440 | 15 | FAZT-B40/3 | 142494 | 1/40 |

SG55912



#### 3+N-poles

|    |     |    |         |    |         |    |             |        |      |
|----|-----|----|---------|----|---------|----|-------------|--------|------|
| 1  | 415 | 15 | 240/415 | 25 | 254/440 | 15 | FAZT-B1/3N  | 241060 | 1/30 |
| 2  | 415 | 15 | 240/415 | 25 | 254/440 | 15 | FAZT-B2/3N  | 241065 | 1/30 |
| 3  | 415 | 15 | 240/415 | 25 | 254/440 | 15 | FAZT-B3/3N  | 241070 | 1/30 |
| 4  | 415 | 15 | 240/415 | 25 | 254/440 | 15 | FAZT-B4/3N  | 241075 | 1/30 |
| 6  | 415 | 15 | 240/415 | 25 | 254/440 | 15 | FAZT-B6/3N  | 241080 | 1/30 |
| 10 | 415 | 15 | 240/415 | 25 | 254/440 | 15 | FAZT-B10/3N | 241085 | 1/30 |
| 12 | 415 | 15 | 240/415 | 25 | 254/440 | 15 | FAZT-B12/3N | 241090 | 1/30 |
| 13 | 415 | 15 | 240/415 | 25 | 254/440 | 15 | FAZT-B13/3N | 241095 | 1/30 |
| 15 | 415 | 15 | 240/415 | 25 | 254/440 | 15 | FAZT-B15/3N | 241100 | 1/30 |
| 16 | 415 | 15 | 240/415 | 25 | 254/440 | 15 | FAZT-B16/3N | 241105 | 1/30 |
| 20 | 415 | 15 | 240/415 | 25 | 254/440 | 15 | FAZT-B20/3N | 241110 | 1/30 |
| 25 | 415 | 15 | 240/415 | 25 | 254/440 | 15 | FAZT-B25/3N | 241115 | 1/30 |
| 32 | 415 | 10 | 240/415 | 20 | 254/440 | 15 | FAZT-B32/3N | 142517 | 1/30 |
| 40 | 415 | 10 | 240/415 | 20 | 254/440 | 15 | FAZT-B40/3N | 142518 | 1/30 |

SG56012



#### 4-poles

|    |     |    |         |    |         |    |            |        |      |
|----|-----|----|---------|----|---------|----|------------|--------|------|
| 1  | 415 | 15 | 240/415 | 25 | 254/440 | 15 | FAZT-B1/4  | 240922 | 1/30 |
| 2  | 415 | 15 | 240/415 | 25 | 254/440 | 15 | FAZT-B2/4  | 240927 | 1/30 |
| 3  | 415 | 15 | 240/415 | 25 | 254/440 | 15 | FAZT-B3/4  | 240930 | 1/30 |
| 4  | 415 | 15 | 240/415 | 25 | 254/440 | 15 | FAZT-B4/4  | 240931 | 1/30 |
| 6  | 415 | 15 | 240/415 | 25 | 254/440 | 15 | FAZT-B6/4  | 240932 | 1/30 |
| 10 | 415 | 15 | 240/415 | 25 | 254/440 | 15 | FAZT-B10/4 | 240933 | 1/30 |
| 12 | 415 | 15 | 240/415 | 25 | 254/440 | 15 | FAZT-B12/4 | 240934 | 1/30 |
| 13 | 415 | 15 | 240/415 | 25 | 254/440 | 15 | FAZT-B13/4 | 240935 | 1/30 |
| 15 | 415 | 15 | 240/415 | 25 | 254/440 | 15 | FAZT-B15/4 | 240936 | 1/30 |
| 16 | 415 | 15 | 240/415 | 25 | 254/440 | 15 | FAZT-B16/4 | 240937 | 1/30 |
| 20 | 415 | 15 | 240/415 | 25 | 254/440 | 15 | FAZT-B20/4 | 240938 | 1/30 |
| 25 | 415 | 15 | 240/415 | 25 | 254/440 | 15 | FAZT-B25/4 | 240939 | 1/30 |
| 32 | 415 | 10 | 240/415 | 20 | 254/440 | 15 | FAZT-B32/4 | 142501 | 1/30 |
| 40 | 415 | 10 | 240/415 | 20 | 254/440 | 15 | FAZT-B40/4 | 142502 | 1/30 |

| Rated current<br>$I_n$ (A) | Rated voltage<br>acc. to<br>IEC/EN<br>60898-1<br>(V) | Breaking<br>capacity<br>acc. to<br>IEC/EN<br>60898-1<br>(kA) | Rated voltage<br>acc. to<br>IEC/EN<br>60947-2<br>(V) | Breaking<br>capacity<br>acc. to<br>IEC/EN<br>60947-2<br>(kA) | Rated voltage<br>acc. to<br>IEC/EN<br>60947-2<br>(V) | Breaking<br>capacity<br>acc. to<br>IEC/EN<br>60947-2<br>(kA) | Type<br>Designation | Article No. | Units per<br>package |
|----------------------------|--|--|--|--|--|--|---------------------|-------------|----------------------|
|----------------------------|--|--|--|--|--|--|---------------------|-------------|----------------------|

**Characteristic C**

SG53212



**1-pole**

|    |     |    |     |    |     |    |            |        |        |
|----|-----|----|-----|----|-----|----|------------|--------|--------|
| 1  | 240 | 15 | 240 | 25 | 254 | 15 | FAZT-C1/1  | 240798 | 12/120 |
| 2  | 240 | 15 | 240 | 25 | 254 | 15 | FAZT-C2/1  | 240799 | 12/120 |
| 3  | 240 | 15 | 240 | 25 | 254 | 15 | FAZT-C3/1  | 240800 | 12/120 |
| 4  | 240 | 15 | 240 | 25 | 254 | 15 | FAZT-C4/1  | 240801 | 12/120 |
| 6  | 240 | 15 | 240 | 25 | 254 | 15 | FAZT-C6/1  | 240802 | 12/120 |
| 10 | 240 | 15 | 240 | 25 | 254 | 15 | FAZT-C10/1 | 240803 | 12/120 |
| 12 | 240 | 15 | 240 | 25 | 254 | 15 | FAZT-C12/1 | 240804 | 12/120 |
| 13 | 240 | 15 | 240 | 25 | 254 | 15 | FAZT-C13/1 | 240805 | 12/120 |
| 15 | 240 | 15 | 240 | 25 | 254 | 15 | FAZT-C15/1 | 240806 | 12/120 |
| 16 | 240 | 15 | 240 | 25 | 254 | 15 | FAZT-C16/1 | 240807 | 12/120 |
| 20 | 240 | 15 | 240 | 25 | 254 | 15 | FAZT-C20/1 | 240808 | 12/120 |
| 25 | 240 | 15 | 240 | 25 | 254 | 15 | FAZT-C25/1 | 240809 | 12/120 |
| 32 | 240 | 10 | 240 | 20 | 254 | 15 | FAZT-C32/1 | 141909 | 12/120 |
| 40 | 240 | 10 | 240 | 20 | 254 | 15 | FAZT-C40/1 | 142480 | 12/120 |

SG5412



**1+N-poles**

|    |     |    |     |    |     |    |             |        |      |
|----|-----|----|-----|----|-----|----|-------------|--------|------|
| 1  | 240 | 15 | 240 | 25 | 254 | 15 | FAZT-C1/1N  | 241022 | 1/60 |
| 2  | 240 | 15 | 240 | 25 | 254 | 15 | FAZT-C2/1N  | 241023 | 1/60 |
| 3  | 240 | 15 | 240 | 25 | 254 | 15 | FAZT-C3/1N  | 241024 | 1/60 |
| 4  | 240 | 15 | 240 | 25 | 254 | 15 | FAZT-C4/1N  | 241025 | 1/60 |
| 6  | 240 | 15 | 240 | 25 | 254 | 15 | FAZT-C6/1N  | 241026 | 1/60 |
| 10 | 240 | 15 | 240 | 25 | 254 | 15 | FAZT-C10/1N | 241027 | 1/60 |
| 12 | 240 | 15 | 240 | 25 | 254 | 15 | FAZT-C12/1N | 241028 | 1/60 |
| 13 | 240 | 15 | 240 | 25 | 254 | 15 | FAZT-C13/1N | 241029 | 1/60 |
| 15 | 240 | 15 | 240 | 25 | 254 | 15 | FAZT-C15/1N | 241030 | 1/60 |
| 16 | 240 | 15 | 240 | 25 | 254 | 15 | FAZT-C16/1N | 241034 | 1/60 |
| 20 | 240 | 15 | 240 | 25 | 254 | 15 | FAZT-C20/1N | 241038 | 1/60 |
| 25 | 240 | 15 | 240 | 25 | 254 | 15 | FAZT-C25/1N | 241044 | 1/60 |
| 32 | 240 | 10 | 240 | 20 | 254 | 15 | FAZT-C32/1N | 142511 | 1/60 |
| 40 | 240 | 10 | 240 | 20 | 254 | 15 | FAZT-C40/1N | 142512 | 1/60 |

SG55212



**2-poles**

|    |     |    |         |    |         |    |            |        |      |
|----|-----|----|---------|----|---------|----|------------|--------|------|
| 1  | 415 | 15 | 240/415 | 25 | 254/440 | 15 | FAZT-C1/2  | 240832 | 1/60 |
| 2  | 415 | 15 | 240/415 | 25 | 254/440 | 15 | FAZT-C2/2  | 240833 | 1/60 |
| 3  | 415 | 15 | 240/415 | 25 | 254/440 | 15 | FAZT-C3/2  | 240838 | 1/60 |
| 4  | 415 | 15 | 240/415 | 25 | 254/440 | 15 | FAZT-C4/2  | 240843 | 1/60 |
| 6  | 415 | 15 | 240/415 | 25 | 254/440 | 15 | FAZT-C6/2  | 240850 | 1/60 |
| 10 | 415 | 15 | 240/415 | 25 | 254/440 | 15 | FAZT-C10/2 | 240855 | 1/60 |
| 12 | 415 | 15 | 240/415 | 25 | 254/440 | 15 | FAZT-C12/2 | 240858 | 1/60 |
| 13 | 415 | 15 | 240/415 | 25 | 254/440 | 15 | FAZT-C13/2 | 240859 | 1/60 |
| 15 | 415 | 15 | 240/415 | 25 | 254/440 | 15 | FAZT-C15/2 | 240860 | 1/60 |
| 16 | 415 | 15 | 240/415 | 25 | 254/440 | 15 | FAZT-C16/2 | 240861 | 1/60 |
| 20 | 415 | 15 | 240/415 | 25 | 254/440 | 15 | FAZT-C20/2 | 240862 | 1/60 |
| 25 | 415 | 15 | 240/415 | 25 | 254/440 | 15 | FAZT-C25/2 | 240863 | 1/60 |
| 32 | 415 | 10 | 240/415 | 20 | 254/440 | 15 | FAZT-C32/2 | 142487 | 1/60 |
| 40 | 415 | 10 | 240/415 | 20 | 254/440 | 15 | FAZT-C40/2 | 142488 | 1/60 |

### FAZ-T Miniature Circuit Breakers

| Rated current<br>$I_n$ (A) | Rated voltage<br>acc. to<br>IEC/EN<br>60898-1<br>(V) | Breaking<br>capacity<br>acc. to<br>IEC/EN<br>60898-1<br>(kA) | Rated voltage<br>acc. to<br>IEC/EN<br>60947-2<br>(V) | Breaking<br>capacity<br>acc. to<br>IEC/EN<br>60947-2<br>(kA) | Rated voltage<br>acc. to<br>IEC/EN<br>60947-2<br>(V) | Breaking<br>capacity<br>acc. to<br>IEC/EN<br>60947-2<br>(kA) | Type<br>Designation | Article No. | Units per<br>package |
|----------------------------|--|--|--|--|--|--|---------------------|-------------|----------------------|
|----------------------------|--|--|--|--|--|--|---------------------|-------------|----------------------|

SG53512



#### 3-poles

|    |     |    |         |    |         |    |            |        |      |
|----|-----|----|---------|----|---------|----|------------|--------|------|
| 1  | 415 | 15 | 240/415 | 25 | 254/440 | 15 | FAZT-C1/3  | 240886 | 1/40 |
| 2  | 415 | 15 | 240/415 | 25 | 254/440 | 15 | FAZT-C2/3  | 240887 | 1/40 |
| 3  | 415 | 15 | 240/415 | 25 | 254/440 | 15 | FAZT-C3/3  | 240888 | 1/40 |
| 4  | 415 | 15 | 240/415 | 25 | 254/440 | 15 | FAZT-C4/3  | 240889 | 1/40 |
| 6  | 415 | 15 | 240/415 | 25 | 254/440 | 15 | FAZT-C6/3  | 240890 | 1/40 |
| 10 | 415 | 15 | 240/415 | 25 | 254/440 | 15 | FAZT-C10/3 | 240891 | 1/40 |
| 12 | 415 | 15 | 240/415 | 25 | 254/440 | 15 | FAZT-C12/3 | 240892 | 1/40 |
| 13 | 415 | 15 | 240/415 | 25 | 254/440 | 15 | FAZT-C13/3 | 240893 | 1/40 |
| 15 | 415 | 15 | 240/415 | 25 | 254/440 | 15 | FAZT-C15/3 | 240894 | 1/40 |
| 16 | 415 | 15 | 240/415 | 25 | 254/440 | 15 | FAZT-C16/3 | 240895 | 1/40 |
| 20 | 415 | 15 | 240/415 | 25 | 254/440 | 15 | FAZT-C20/3 | 240896 | 1/40 |
| 25 | 415 | 15 | 240/415 | 25 | 254/440 | 15 | FAZT-C25/3 | 240897 | 1/40 |
| 32 | 415 | 10 | 240/415 | 20 | 254/440 | 15 | FAZT-C32/3 | 142495 | 1/40 |
| 40 | 415 | 10 | 240/415 | 20 | 254/440 | 15 | FAZT-C40/3 | 142496 | 1/40 |

SG55912



#### 3+N-poles

|    |     |    |         |    |         |    |             |        |      |
|----|-----|----|---------|----|---------|----|-------------|--------|------|
| 1  | 415 | 15 | 240/415 | 25 | 254/440 | 15 | FAZT-C1/3N  | 241120 | 1/30 |
| 2  | 415 | 15 | 240/415 | 25 | 254/440 | 15 | FAZT-C2/3N  | 241125 | 1/30 |
| 3  | 415 | 15 | 240/415 | 25 | 254/440 | 15 | FAZT-C3/3N  | 241130 | 1/30 |
| 4  | 415 | 15 | 240/415 | 25 | 254/440 | 15 | FAZT-C4/3N  | 241135 | 1/30 |
| 6  | 415 | 15 | 240/415 | 25 | 254/440 | 15 | FAZT-C6/3N  | 241140 | 1/30 |
| 10 | 415 | 15 | 240/415 | 25 | 254/440 | 15 | FAZT-C10/3N | 241145 | 1/30 |
| 12 | 415 | 15 | 240/415 | 25 | 254/440 | 15 | FAZT-C12/3N | 241150 | 1/30 |
| 13 | 415 | 15 | 240/415 | 25 | 254/440 | 15 | FAZT-C13/3N | 241155 | 1/30 |
| 15 | 415 | 15 | 240/415 | 25 | 254/440 | 15 | FAZT-C15/3N | 241160 | 1/30 |
| 16 | 415 | 15 | 240/415 | 25 | 254/440 | 15 | FAZT-C16/3N | 241165 | 1/30 |
| 20 | 415 | 15 | 240/415 | 25 | 254/440 | 15 | FAZT-C20/3N | 241170 | 1/30 |
| 25 | 415 | 15 | 240/415 | 25 | 254/440 | 15 | FAZT-C25/3N | 241175 | 1/30 |
| 32 | 415 | 10 | 240/415 | 20 | 254/440 | 15 | FAZT-C32/3N | 142519 | 1/30 |
| 40 | 415 | 10 | 240/415 | 20 | 254/440 | 15 | FAZT-C40/3N | 142520 | 1/30 |

SG56012



#### 4-poles

|    |     |    |         |    |         |    |            |        |      |
|----|-----|----|---------|----|---------|----|------------|--------|------|
| 1  | 415 | 15 | 240/415 | 25 | 254/440 | 15 | FAZT-C1/4  | 240940 | 1/30 |
| 2  | 415 | 15 | 240/415 | 25 | 254/440 | 15 | FAZT-C2/4  | 240941 | 1/30 |
| 3  | 415 | 15 | 240/415 | 25 | 254/440 | 15 | FAZT-C3/4  | 240945 | 1/30 |
| 4  | 415 | 15 | 240/415 | 25 | 254/440 | 15 | FAZT-C4/4  | 240949 | 1/30 |
| 6  | 415 | 15 | 240/415 | 25 | 254/440 | 15 | FAZT-C6/4  | 240955 | 1/30 |
| 10 | 415 | 15 | 240/415 | 25 | 254/440 | 15 | FAZT-C10/4 | 240959 | 1/30 |
| 12 | 415 | 15 | 240/415 | 25 | 254/440 | 15 | FAZT-C12/4 | 240962 | 1/30 |
| 13 | 415 | 15 | 240/415 | 25 | 254/440 | 15 | FAZT-C13/4 | 240963 | 1/30 |
| 15 | 415 | 15 | 240/415 | 25 | 254/440 | 15 | FAZT-C15/4 | 240964 | 1/30 |
| 16 | 415 | 15 | 240/415 | 25 | 254/440 | 15 | FAZT-C16/4 | 240965 | 1/30 |
| 20 | 415 | 15 | 240/415 | 25 | 254/440 | 15 | FAZT-C20/4 | 240966 | 1/30 |
| 25 | 415 | 15 | 240/415 | 25 | 254/440 | 15 | FAZT-C25/4 | 240967 | 1/30 |
| 32 | 415 | 10 | 240/415 | 20 | 254/440 | 15 | FAZT-C32/4 | 142503 | 1/30 |
| 40 | 415 | 10 | 240/415 | 20 | 254/440 | 15 | FAZT-C40/4 | 142504 | 1/30 |

| Rated current<br>$I_n$ (A) | Rated voltage<br>acc. to<br>IEC/EN<br>60898-1<br>(V) | Breaking<br>capacity<br>acc. to<br>IEC/EN<br>60898-1<br>(kA) | Rated voltage<br>acc. to<br>IEC/EN<br>60947-2<br>(V) | Breaking<br>capacity<br>acc. to<br>IEC/EN<br>60947-2<br>(kA) | Type<br>Designation | Article No. | Units per<br>package |
|----------------------------|--|--|--|--|---------------------|-------------|----------------------|
|----------------------------|--|--|--|--|---------------------|-------------|----------------------|

**Characteristic D**

SG53212



**1-pole**

|    |     |    |     |    |            |        |        |
|----|-----|----|-----|----|------------|--------|--------|
| 1  | 240 | 15 | 240 | 25 | FAZT-D1/1  | 240810 | 12/120 |
| 2  | 240 | 15 | 240 | 25 | FAZT-D2/1  | 240811 | 12/120 |
| 3  | 240 | 15 | 240 | 25 | FAZT-D3/1  | 240812 | 12/120 |
| 4  | 240 | 15 | 240 | 25 | FAZT-D4/1  | 240813 | 12/120 |
| 6  | 240 | 15 | 240 | 25 | FAZT-D6/1  | 240814 | 12/120 |
| 10 | 240 | 15 | 240 | 25 | FAZT-D10/1 | 240815 | 12/120 |
| 12 | 240 | 15 | 240 | 25 | FAZT-D12/1 | 240816 | 12/120 |
| 13 | 240 | 15 | 240 | 25 | FAZT-D13/1 | 240817 | 12/120 |
| 15 | 240 | 15 | 240 | 20 | FAZT-D15/1 | 240818 | 12/120 |
| 16 | 240 | 15 | 240 | 20 | FAZT-D16/1 | 240819 | 12/120 |
| 20 | 240 | 10 | 240 | 20 | FAZT-D20/1 | 142481 | 12/120 |
| 25 | 240 | 10 | 240 | 15 | FAZT-D25/1 | 142482 | 12/120 |
| 32 | 240 | 10 | 240 | 15 | FAZT-D32/1 | 142483 | 12/120 |
| 40 | 240 | 10 | 240 | 15 | FAZT-D40/1 | 142484 | 12/120 |

SG5412



**1+N-poles**

|    |     |    |     |    |             |        |      |
|----|-----|----|-----|----|-------------|--------|------|
| 1  | 240 | 15 | 240 | 25 | FAZT-D1/1N  | 241048 | 1/60 |
| 2  | 240 | 15 | 240 | 25 | FAZT-D2/1N  | 241051 | 1/60 |
| 3  | 240 | 15 | 240 | 25 | FAZT-D3/1N  | 241052 | 1/60 |
| 4  | 240 | 15 | 240 | 25 | FAZT-D4/1N  | 241053 | 1/60 |
| 6  | 240 | 15 | 240 | 25 | FAZT-D6/1N  | 241054 | 1/60 |
| 10 | 240 | 15 | 240 | 25 | FAZT-D10/1N | 241055 | 1/60 |
| 12 | 240 | 15 | 240 | 25 | FAZT-D12/1N | 241056 | 1/60 |
| 13 | 240 | 15 | 240 | 25 | FAZT-D13/1N | 241057 | 1/60 |
| 15 | 240 | 15 | 240 | 20 | FAZT-D15/1N | 241058 | 1/60 |
| 16 | 240 | 15 | 240 | 20 | FAZT-D16/1N | 241059 | 1/60 |
| 20 | 240 | 10 | 240 | 20 | FAZT-D20/1N | 142513 | 1/60 |
| 25 | 240 | 10 | 240 | 15 | FAZT-D25/1N | 142514 | 1/60 |
| 32 | 240 | 10 | 240 | 15 | FAZT-D32/1N | 142515 | 1/60 |
| 40 | 240 | 10 | 240 | 15 | FAZT-D40/1N | 142516 | 1/60 |

SG55212



**2-poles**

|    |     |    |         |    |            |        |      |
|----|-----|----|---------|----|------------|--------|------|
| 1  | 415 | 15 | 240/415 | 25 | FAZT-D1/2  | 240864 | 1/60 |
| 2  | 415 | 15 | 240/415 | 25 | FAZT-D2/2  | 240865 | 1/60 |
| 3  | 415 | 15 | 240/415 | 25 | FAZT-D3/2  | 240866 | 1/60 |
| 4  | 415 | 15 | 240/415 | 25 | FAZT-D4/2  | 240867 | 1/60 |
| 6  | 415 | 15 | 240/415 | 25 | FAZT-D6/2  | 240868 | 1/60 |
| 10 | 415 | 15 | 240/415 | 25 | FAZT-D10/2 | 240869 | 1/60 |
| 12 | 415 | 15 | 240/415 | 25 | FAZT-D12/2 | 240870 | 1/60 |
| 13 | 415 | 15 | 240/415 | 25 | FAZT-D13/2 | 240871 | 1/60 |
| 15 | 415 | 15 | 240/415 | 20 | FAZT-D15/2 | 240872 | 1/60 |
| 16 | 415 | 15 | 240/415 | 20 | FAZT-D16/2 | 240873 | 1/60 |
| 20 | 415 | 10 | 240/415 | 20 | FAZT-D20/2 | 142489 | 1/60 |
| 25 | 415 | 10 | 240/415 | 15 | FAZT-D25/2 | 142490 | 1/60 |
| 32 | 415 | 10 | 240/415 | 15 | FAZT-D32/2 | 142491 | 1/60 |
| 40 | 415 | 10 | 240/415 | 15 | FAZT-D40/2 | 142492 | 1/60 |

### FAZ-T Miniature Circuit Breakers

| Rated current<br>$I_n$ (A) | Rated voltage<br>acc. to<br>IEC/EN<br>60898-1<br>(V) | Breaking<br>capacity<br>acc. to<br>IEC/EN<br>60898-1<br>(kA) | Rated voltage<br>acc. to<br>IEC/EN<br>60947-2<br>(V) | Breaking<br>capacity<br>acc. to<br>IEC/EN<br>60947-2<br>(kA) | Type<br>Designation | Article No. | Units per<br>package |
|----------------------------|--|--|--|--|---------------------|-------------|----------------------|
|----------------------------|--|--|--|--|---------------------|-------------|----------------------|

SG55612



#### 3-poles

|    |     |    |         |    |            |        |      |
|----|-----|----|---------|----|------------|--------|------|
| 1  | 415 | 15 | 240/415 | 25 | FAZT-D1/3  | 240898 | 1/40 |
| 2  | 415 | 15 | 240/415 | 25 | FAZT-D2/3  | 240899 | 1/40 |
| 3  | 415 | 15 | 240/415 | 25 | FAZT-D3/3  | 240900 | 1/40 |
| 4  | 415 | 15 | 240/415 | 25 | FAZT-D4/3  | 240901 | 1/40 |
| 6  | 415 | 15 | 240/415 | 25 | FAZT-D6/3  | 240902 | 1/40 |
| 10 | 415 | 15 | 240/415 | 25 | FAZT-D10/3 | 240903 | 1/40 |
| 12 | 415 | 15 | 240/415 | 25 | FAZT-D12/3 | 240904 | 1/40 |
| 13 | 415 | 15 | 240/415 | 25 | FAZT-D13/3 | 240905 | 1/40 |
| 15 | 415 | 15 | 240/415 | 25 | FAZT-D15/3 | 240910 | 1/40 |
| 16 | 415 | 15 | 240/415 | 25 | FAZT-D16/3 | 240915 | 1/40 |
| 20 | 415 | 10 | 240/415 | 20 | FAZT-D20/3 | 142497 | 1/40 |
| 25 | 415 | 10 | 240/415 | 15 | FAZT-D25/3 | 142498 | 1/40 |
| 32 | 415 | 10 | 240/415 | 15 | FAZT-D32/3 | 142499 | 1/40 |
| 40 | 415 | 10 | 240/415 | 15 | FAZT-D40/3 | 142500 | 1/40 |

SG55912



#### 3+N-poles

|    |     |    |         |    |             |        |      |
|----|-----|----|---------|----|-------------|--------|------|
| 1  | 415 | 15 | 240/415 | 25 | FAZT-D1/3N  | 241180 | 1/30 |
| 2  | 415 | 15 | 240/415 | 25 | FAZT-D2/3N  | 241181 | 1/30 |
| 3  | 415 | 15 | 240/415 | 25 | FAZT-D3/3N  | 241182 | 1/30 |
| 4  | 415 | 15 | 240/415 | 25 | FAZT-D4/3N  | 241183 | 1/30 |
| 6  | 415 | 15 | 240/415 | 25 | FAZT-D6/3N  | 241184 | 1/30 |
| 10 | 415 | 15 | 240/415 | 25 | FAZT-D10/3N | 241185 | 1/30 |
| 12 | 415 | 15 | 240/415 | 25 | FAZT-D12/3N | 241186 | 1/30 |
| 13 | 415 | 15 | 240/415 | 25 | FAZT-D13/3N | 241187 | 1/30 |
| 15 | 415 | 15 | 240/415 | 25 | FAZT-D15/3N | 241188 | 1/30 |
| 16 | 415 | 15 | 240/415 | 25 | FAZT-D16/3N | 241189 | 1/30 |
| 20 | 415 | 10 | 240/415 | 20 | FAZT-D20/3N | 142521 | 1/30 |
| 25 | 415 | 10 | 240/415 | 15 | FAZT-D25/3N | 142522 | 1/30 |
| 32 | 415 | 10 | 240/415 | 15 | FAZT-D32/3N | 142523 | 1/30 |
| 40 | 415 | 10 | 240/415 | 15 | FAZT-D40/3N | 142524 | 1/30 |

SG56012



#### 4-poles

|    |     |    |         |    |            |        |      |
|----|-----|----|---------|----|------------|--------|------|
| 1  | 415 | 15 | 240/415 | 25 | FAZT-D1/4  | 240968 | 1/30 |
| 2  | 415 | 15 | 240/415 | 25 | FAZT-D2/4  | 240969 | 1/30 |
| 3  | 415 | 15 | 240/415 | 25 | FAZT-D3/4  | 240970 | 1/30 |
| 4  | 415 | 15 | 240/415 | 25 | FAZT-D4/4  | 240971 | 1/30 |
| 6  | 415 | 15 | 240/415 | 25 | FAZT-D6/4  | 240975 | 1/30 |
| 10 | 415 | 15 | 240/415 | 25 | FAZT-D10/4 | 240979 | 1/30 |
| 12 | 415 | 15 | 240/415 | 25 | FAZT-D12/4 | 240985 | 1/30 |
| 13 | 415 | 15 | 240/415 | 25 | FAZT-D13/4 | 240989 | 1/30 |
| 15 | 415 | 15 | 240/415 | 25 | FAZT-D15/4 | 240992 | 1/30 |
| 16 | 415 | 15 | 240/415 | 25 | FAZT-D16/4 | 240993 | 1/30 |
| 20 | 415 | 10 | 240/415 | 20 | FAZT-D20/4 | 142505 | 1/30 |
| 25 | 415 | 10 | 240/415 | 15 | FAZT-D25/4 | 142506 | 1/30 |
| 32 | 415 | 10 | 240/415 | 15 | FAZT-D32/4 | 142507 | 1/30 |
| 40 | 415 | 10 | 240/415 | 15 | FAZT-D40/4 | 142508 | 1/30 |



**Technical Data**

|  |           | <b>FAZ-T</b>   |
|--|-----------|--|
| Productstandard  |           | IEC/EN 60947-2, IEC/EN 60898-1   |
| Classified according to  |           | IEC 61373, EN 45545-2  |
| Current test marks as printed onto the device                            |           |  |
| Number of poles  |           | 1, 1p+N, 2, 3, 3p+N, 4   |
| <b>Mechanical</b>  |           |  |
| Device width   |           | 17.7 mm (1p), 27 mm (1p+N), 36 mm (2p), 54 mm (3p), 72 mm (3p+N), 72 mm (4p)   |
| Frame size   |           | 45 mm  |
| Device height  |           | 80 mm  |
| Device depth   |           | 60 mm  |
| Terminals  |           | lift terminal  |
| Terminal capacity rigid solid/stranded wire                              |           | 1-25 mm <sup>2</sup>   |
| Terminal screw   |           | M5 (with slotted screw acc. to EN ISO 4757-Z2, PZ2)  |
| Fastening torque of terminal screws                                      |           | max. 2.4 Nm  |
| Snap on fixing   |           | tristable (on DIN rail acc. to EN 50022)   |
| Finger proof   |           | acc. to VBG4, ÖVE EN-6   |
| Degree of protection (DIN VDE 0470)                                      |           |  |
| Surface mounted  |           | IP20   |
| Built-in behind panel  |           | IP40   |
| Contact position indicator   |           | red / green  |
| <b>Electrical</b>  |           |  |
| Rated voltage  | $U_n$     | 255/440 V AC (Characteristic B, C), 240/415 V AC (Characteristic D)<br>60 V DC per pole  |
| Rated current  | $I_n$     | Type B, C, D: 1, 2, 3, 4, 6, 10, 12, 13, 15, 16, 20, 25, 32, 40 A  |
| Rated insulation voltage   | $U_i$     | 440 V AC   |
| Rated impulse withstand voltage  | $U_{imp}$ | 4 kV (1.2/50) $\mu$ sec  |
| <b>Tripping characteristic</b>   |           |  |
| Conventional non-tripping current  |           | $I_{nt} = 1,13 I_n$  |
| Conventional tripping current  |           | $I_t = 1,45 I_n$   |
| Reference temperature  |           | 40 °C  |
| Temperature factor   |           | 0.4%/K   |
| Instantaneous tripping current   | $I_{mt}$  | Type B: $3 I_n < I_{mt} = 5 I_n \cdot t (I_{mt}) < 0.1 \text{ sec}$<br>Type C: $5 I_n < I_{mt} = 10 I_n \cdot t (I_{mt}) < 0.1 \text{ sec}$<br>Type D: $10 I_n < I_{mt} = 20 I_n \cdot t (I_{mt}) < 0.1 \text{ sec}$   |
| Rated ultimate short-circuit breaking capacity $I_{cu}$ (IEC/EN 60947-2) |           | Type B 1-25 A: 25 kA, 32-40 A: 20 kA<br>Type C 1-25 A: 25 kA, 32-40 A: 20 kA<br>Type D 1p/1p+N/2p - 1-13 A: 25 kA, 15-20 A: 20 kA, 25-40 A: 15 kA<br>3p/3p+N/4p - 1-16 A: 25 kA, 20 A: 20 kA, 25-40 A: 15 kA   |
| Rated service short-circuit breaking capacity $I_{cs}$ (IEC/EN 60947-2)  |           | for $I_{cu} = 25 \text{ kA} \rightarrow I_{cs} = 12.5 \text{ kA}$ : 240/415 V AC; $I_{cu} = 15 \text{ kA}$ : 255/440 V AC<br>for $I_{cu} = 20 \text{ kA} \rightarrow I_{cs} = 10 \text{ kA}$ : 240/415 V AC; $I_{cu} = 15 \text{ kA}$ : 255/440 V AC<br>for $I_{cu} = 15 \text{ kA} \rightarrow I_{cs} = 7.5 \text{ kA}$ |
| Rated short-circuit breaking capacity $I_{cn}$ (IEC/EN 60898-1)          |           | Type B 1-25 A: 15 kA, 32-40 A: 10 kA<br>Type C 1-25 A: 15 kA, 32-40 A: 10 kA<br>Type D 1-16 A: 15 kA, 20-40 A: 10 kA   |
| Selectivity class  |           | 3 (acc. to EN 60898)   |
| Number of electrical operations  |           | > 4.000 (IEC/EN 60898)   |
| Number of mechanical operations  |           | > 10,000 (IEC/EN 60947)  |
| Climatic conditions  |           | acc. to IEC 60068-2-30 (25..55°C / 90..95% RH)   |
| Operating temperature range  |           | -40°C up to +75°C  |
| Storage- and transport temperature                                       |           | -40°C up to +75°C  |

**Connection diagram**

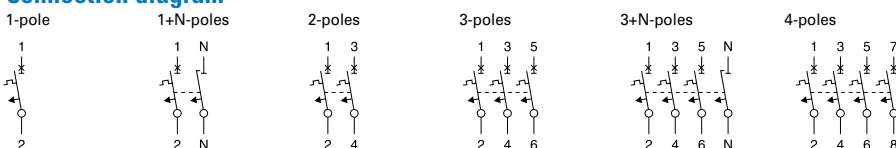

### Dimensions (mm) FAZ-T

1-pole

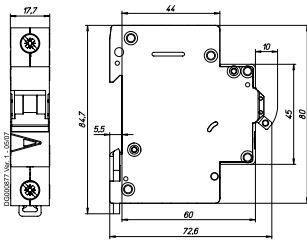

1+N-poles

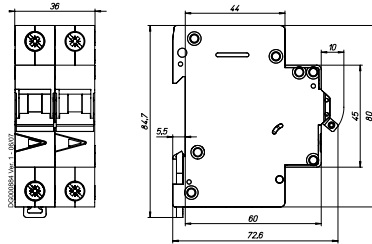

2-poles

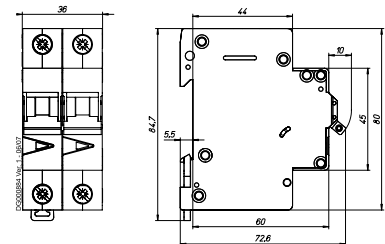

3-poles

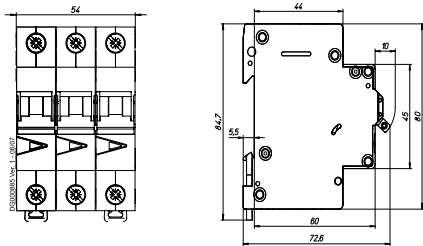

3+N-poles, 4-poles

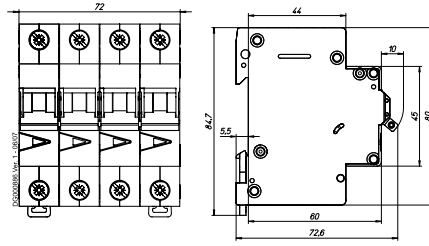

### Tripping Characteristics FAZ-T

Characteristics B, C and D - EN60898

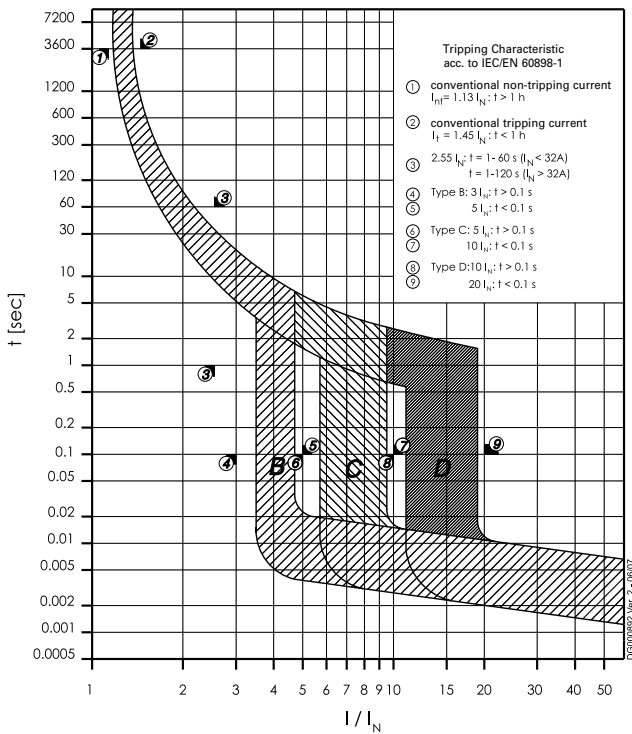

**Power Loss at  $I_n$  FAZ-T (50/60 Hz)**

| <b>Type B</b> |             |              |             |             |               |             |
|---------------|-------------|--------------|-------------|-------------|---------------|-------------|
| $I_n$ [A]     | 1p<br>P [W] | 1pN<br>P [W] | 2p<br>P [W] | 3p<br>P [W] | 3pN*<br>P [W] | 4p<br>P [W] |
| 1             | 1.6         | 1.7          | 3.1         | 4.7         | 4.8           | 6.3         |
| 2             | 1.4         | 1.5          | 2.8         | 4.1         | 4.3           | 5.5         |
| 3             | 2.5         | 2.7          | 5.0         | 7.6         | 7.8           | 10.1        |
| 4             | 1.4         | 1.6          | 2.9         | 4.4         | 4.5           | 5.8         |
| 6             | 1.8         | 2.0          | 3.6         | 5.5         | 5.6           | 7.3         |
| 10            | 1.9         | 2.1          | 3.9         | 5.9         | 6.1           | 7.8         |
| 12            | 2.8         | 3.2          | 5.9         | 8.7         | 9.0           | 11.5        |
| 13            | 2.5         | 2.9          | 5.3         | 7.8         | 8.1           | 10.3        |
| 15            | 2.1         | 2.4          | 4.4         | 6.5         | 6.7           | 8.6         |
| 16            | 2.2         | 2.6          | 4.7         | 6.9         | 7.2           | 9.1         |
| 20            | 3.2         | 3.6          | 6.6         | 9.8         | 10.1          | 13.0        |
| 25            | 3.0         | 3.5          | 6.4         | 9.4         | 9.7           | 12.4        |
| 32            | 3.7         | 4.4          | 8.1         | 12.1        | 12.5          | 15.8        |
| 40            | 3.4         | 4.1          | 7.5         | 11.2        | 11.5          | 14.6        |

\* symmetrical load

| <b>Type C</b> |             |              |             |             |               |             |
|---------------|-------------|--------------|-------------|-------------|---------------|-------------|
| $I_n$ [A]     | 1p<br>P [W] | 1pN<br>P [W] | 2p<br>P [W] | 3p<br>P [W] | 3pN*<br>P [W] | 4p<br>P [W] |
| 1             | 1.6         | 1.7          | 3.1         | 4.7         | 4.8           | 6.3         |
| 2             | 1.4         | 1.5          | 2.8         | 4.1         | 4.3           | 5.5         |
| 3             | 1.2         | 1.3          | 2.4         | 3.6         | 3.7           | 4.8         |
| 4             | 1.4         | 1.6          | 2.9         | 4.4         | 4.5           | 5.8         |
| 6             | 1.5         | 1.6          | 2.9         | 4.4         | 4.6           | 5.9         |
| 10            | 1.5         | 1.7          | 3.0         | 4.6         | 4.7           | 6.1         |
| 12            | 2.1         | 2.4          | 4.4         | 6.5         | 6.8           | 8.6         |
| 13            | 2.5         | 2.9          | 5.3         | 7.8         | 8.1           | 10.3        |
| 15            | 2.1         | 2.4          | 4.4         | 6.5         | 6.7           | 8.6         |
| 16            | 2.2         | 2.6          | 4.7         | 6.9         | 7.2           | 9.1         |
| 20            | 3.2         | 3.6          | 6.6         | 9.8         | 10.1          | 13.0        |
| 25            | 3.0         | 3.5          | 6.4         | 9.4         | 9.7           | 12.4        |
| 32            | 3.7         | 4.4          | 8.1         | 12.1        | 12.5          | 15.8        |
| 40            | 3.4         | 4.1          | 7.5         | 11.2        | 11.5          | 14.6        |

\* symmetrical load

| <b>Type D</b> |             |              |             |             |               |             |
|---------------|-------------|--------------|-------------|-------------|---------------|-------------|
| $I_n$ [A]     | 1p<br>P [W] | 1pN<br>P [W] | 2p<br>P [W] | 3p<br>P [W] | 3pN*<br>P [W] | 4p<br>P [W] |
| 1             | 0.8         | 0.9          | 1.6         | 2.4         | 2.5           | 3.2         |
| 2             | 1.0         | 1.1          | 2.0         | 3.0         | 3.1           | 4.0         |
| 3             | 1.2         | 1.3          | 2.4         | 3.6         | 3.7           | 4.8         |
| 4             | 1.4         | 1.6          | 2.9         | 4.4         | 4.5           | 5.8         |
| 6             | 1.5         | 1.6          | 2.9         | 4.4         | 4.6           | 5.9         |
| 10            | 1.5         | 1.7          | 3.0         | 4.6         | 4.7           | 6.1         |
| 12            | 1.7         | 2.0          | 3.6         | 5.3         | 5.4           | 7.0         |
| 13            | 1.9         | 2.2          | 4.0         | 5.9         | 6.1           | 7.8         |
| 15            | 2.1         | 2.4          | 4.4         | 6.5         | 6.7           | 8.6         |
| 16            | 2.2         | 2.6          | 4.7         | 6.9         | 7.2           | 9.1         |
| 20            | 2.0         | 2.2          | 4.1         | 6.1         | 6.2           | 8.1         |
| 25            | 2.5         | 2.9          | 5.2         | 7.7         | 7.9           | 10.2        |
| 32            | 3.4         | 4.0          | 7.4         | 11.1        | 11.4          | 14.5        |
| 40            | 3.2         | 3.8          | 7.0         | 10.4        | 10.7          | 13.6        |

\* symmetrical load

**Influence of Ambient Temperature FAZ-T**

On Load Carrying Capacity (temperature derating)

| $I_n$ [A] | Ambient temperature T [°C] |     |     |     |     |     |     |    |      |      |      |      |     |      |      |      |      |
|-----------|----------------------------|-----|-----|-----|-----|-----|-----|----|------|------|------|------|-----|------|------|------|------|
|           | -40                        | -30 | -20 | -10 | 0   | 10  | 20  | 30 | 35   | 40   | 45   | 50   | 55  | 60   | 65   | 70   | 75   |
| 1         | 1.3                        | 1.2 | 1.2 | 1.2 | 1.1 | 1.1 | 1   | 1  | 0.99 | 0.97 | 0.95 | 0.93 | 0.9 | 0.89 | 0.87 | 0.85 | 0.83 |
| 2         | 2.6                        | 2.5 | 2.4 | 2.3 | 2.2 | 2.2 | 2.1 | 2  | 2    | 1.9  | 1.9  | 1.9  | 1.8 | 1.8  | 1.7  | 1.7  | 1.7  |
| 3         | 3.8                        | 3.7 | 3.6 | 3.5 | 3.4 | 3.3 | 3.1 | 3  | 3    | 2.9  | 2.8  | 2.8  | 2.7 | 2.7  | 2.6  | 2.5  | 2.5  |
| 4         | 5.1                        | 5   | 4.8 | 4.7 | 4.5 | 4.3 | 4.2 | 4  | 3.9  | 3.9  | 3.8  | 3.7  | 3.6 | 3.5  | 3.5  | 3.4  | 3.3  |
| 6         | 7.7                        | 7.5 | 7.2 | 7   | 6.7 | 6.5 | 6.3 | 6  | 5.9  | 5.8  | 5.7  | 5.6  | 5.4 | 5.3  | 5.2  | 5.1  | 5    |
| 10        | 13                         | 12  | 12  | 12  | 11  | 11  | 10  | 10 | 9.9  | 9.7  | 9.5  | 9.3  | 9   | 8.9  | 8.7  | 8.5  | 8.3  |
| 12        | 15                         | 15  | 14  | 14  | 13  | 13  | 13  | 12 | 12   | 12   | 11   | 11   | 11  | 11   | 10   | 10   | 10   |
| 13        | 17                         | 16  | 16  | 15  | 15  | 14  | 14  | 13 | 13   | 13   | 12   | 12   | 12  | 12   | 11   | 11   | 11   |
| 15        | 19                         | 19  | 18  | 17  | 17  | 16  | 16  | 15 | 15   | 15   | 14   | 14   | 14  | 13   | 13   | 13   | 12   |
| 16        | 20                         | 20  | 19  | 19  | 18  | 17  | 17  | 16 | 16   | 15   | 15   | 15   | 14  | 14   | 14   | 14   | 13   |
| 20        | 26                         | 25  | 24  | 23  | 22  | 22  | 21  | 20 | 20   | 19   | 19   | 19   | 18  | 18   | 17   | 17   | 17   |
| 25        | 32                         | 31  | 30  | 29  | 28  | 27  | 26  | 25 | 25   | 24   | 24   | 23   | 23  | 22   | 22   | 21   | 21   |
| 32        | 41                         | 40  | 38  | 37  | 36  | 35  | 33  | 32 | 32   | 31   | 30   | 30   | 29  | 28   | 28   | 27   | 26   |
| 40        | 51                         | 50  | 48  | 47  | 45  | 43  | 42  | 40 | 39   | 39   | 38   | 37   | 36  | 35   | 35   | 34   | 33   |

### Maximum Let-Through Energy FAZ-T

Type B

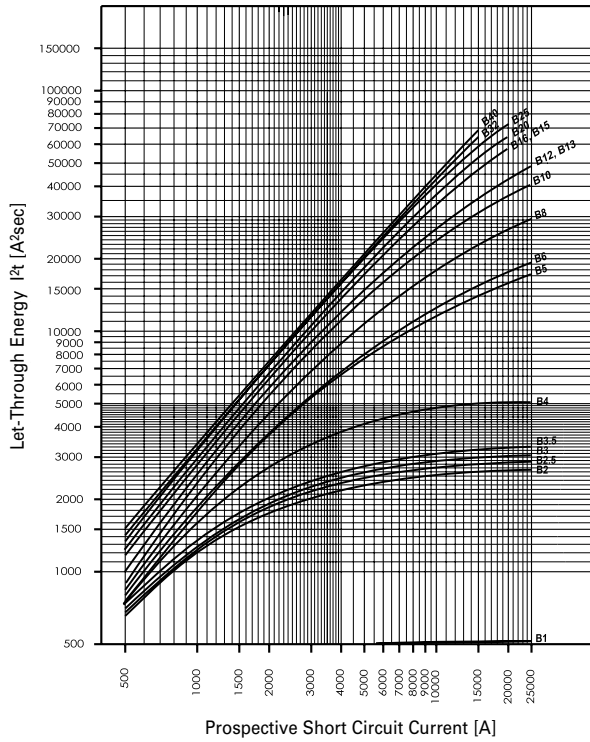

Type C

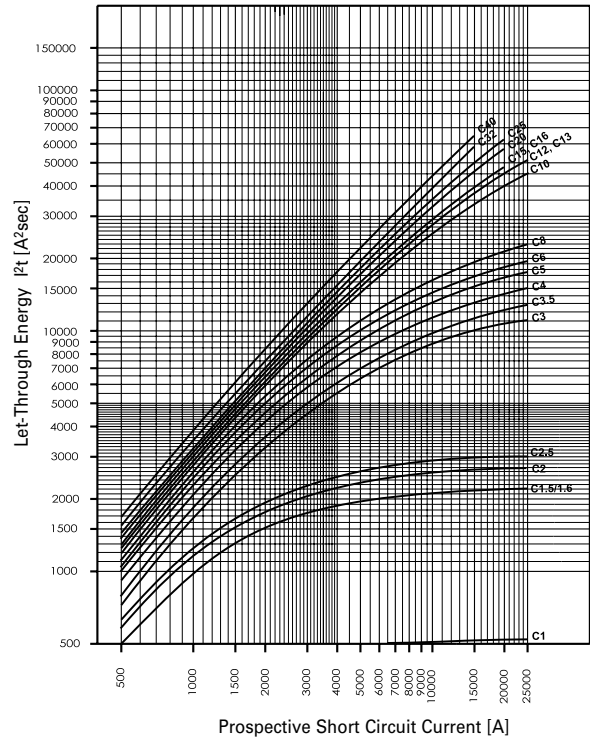

Type D

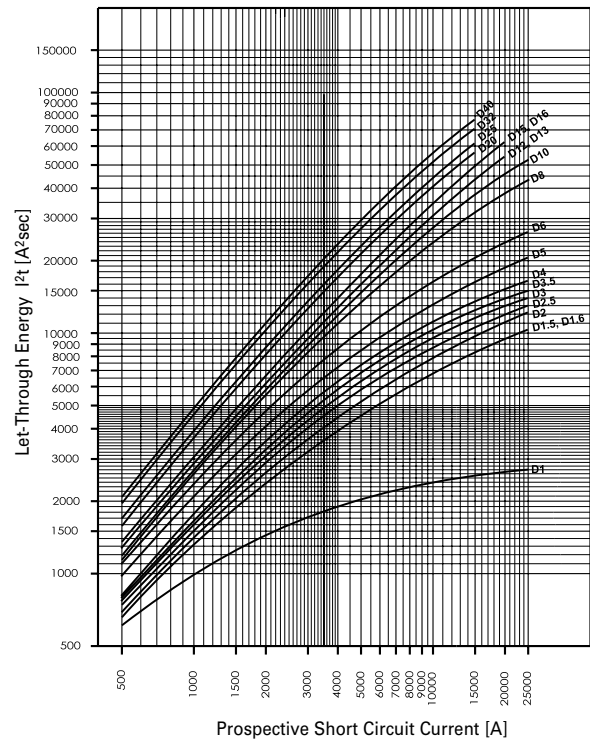

Maximum Let-Through Current FAZ-T

Type B

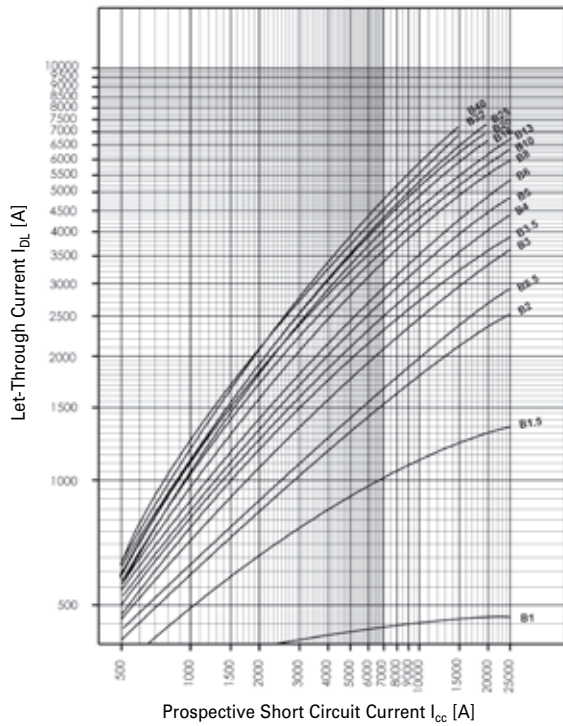

Type C

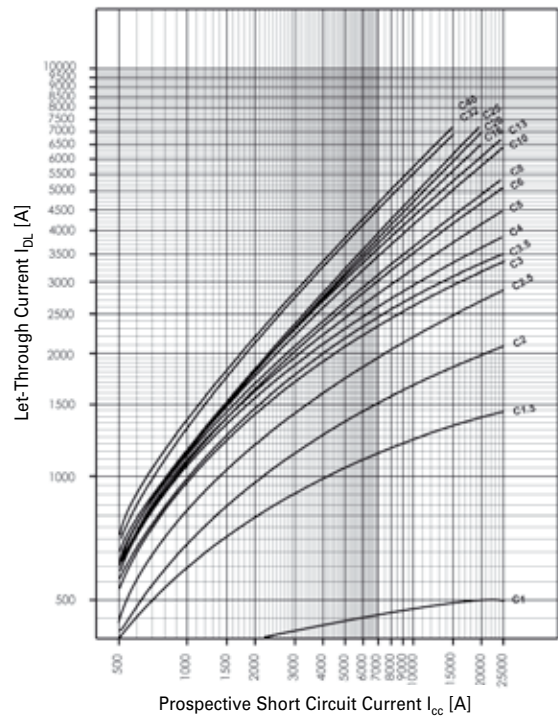

Type D

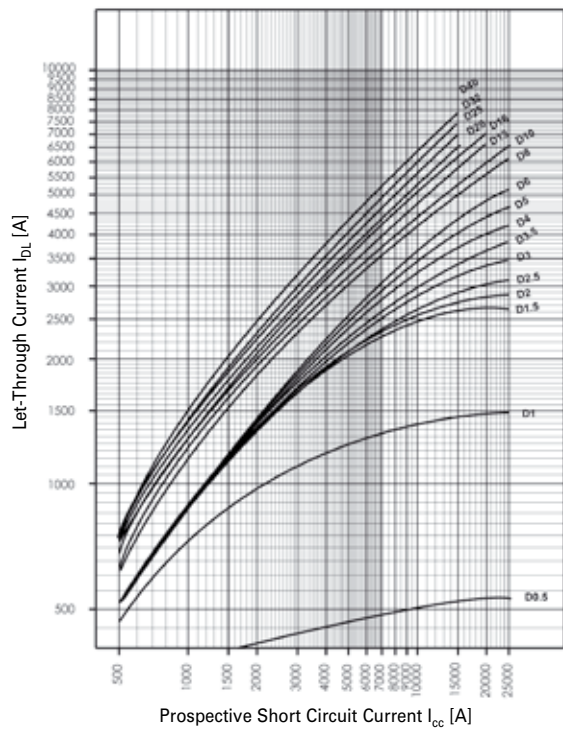

### Influence of the Line Frequency FAZ-T

On the Instantaneous Tripping Current  $I_{MA}$

|                                      | Line Frequency f [Hz]          |     |     |     |     |     |     |
|--------------------------------------|--------------------------------|-----|-----|-----|-----|-----|-----|
|                                      | 16 <sup>2</sup> / <sub>3</sub> | 50  | 60  | 100 | 200 | 300 | 400 |
| $I_{MA}(f)/I_{MA}(50\text{ Hz})$ [%] | 91                             | 100 | 101 | 106 | 115 | 134 | 141 |

The use of the products in networks with other frequencies than 50/60 Hz are in the customer's responsibility.

### Load rating in case of circuit breakers arranged one next to the other FAZ-T

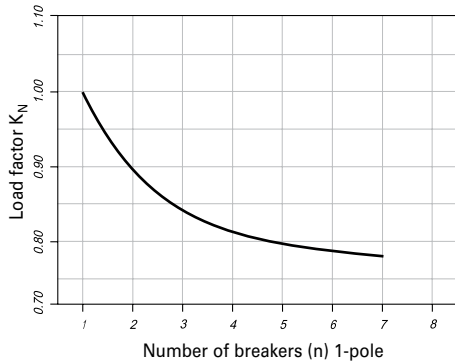

### Derating table for FAZ/FAZ-T above 2000m sea level

| 60898          | 60947                |          |              |
|----------------|----------------------|----------|--------------|
| $U_n$ 230/400V | $U_n$ 230/400V       |          |              |
| B, C, D ≤63A   | B, C ≤63A and D ≤40A | D50, D63 | B, C, D ≤63A |

| Above sea level (m) | Overvoltage category | Disconnect function | $I/I_n$ | $I_{cn}$ | $I_{cs}$ | $I_{cu}$ |    | $I_{cs}$ |
|---------------------|----------------------|---------------------|---------|----------|----------|----------|----|----------|
| m                   | x                    | x                   | x       | kA       | kA       | kA       | kA | kA       |
| ≤2000               | III                  | yes                 | 1       | 10       | 7.5      | 15       | 10 | 7.5      |
| >2000-2500          | II                   | no                  | 0.93    | 6        | 6        | 10       | 6  | 6        |
| >2500-3000          | II                   | no                  | 0.88    | 6        | 6        | 10       | 6  | 6        |
| >3000-3500          | II                   | no                  | 0.83    | 6        | 6        | 10       | 6  | 6        |
| >3500-4000          | II                   | no                  | 0.78    | 6        | 6        | 10       | 6  | 6        |

Eaton's electrical business is a global leader with deep regional application expertise in power distribution and circuit protection; power quality, backup power and energy storage; control and automation; life safety and security; structural solutions; and harsh and hazardous environment solutions. Through end-to-end services, channel and an integrated digital platform & insights Eaton is powering what matters across industries and around the world, helping customers solve their most critical electrical power management challenges.

For more information, visit [Eaton.com](https://www.eaton.com).



**Eaton Industries (Austria) GmbH**  
Scheydgasse 42  
1210 Vienna  
Austria

**Eaton**  
EMEA Headquarters  
Route de la Longeraie 7  
1110 Morges, Switzerland

© 2022 Eaton  
All Rights Reserved  
Publication No. CA003035EN  
Article number 304271-MK  
February 2022

Changes to the products, to the information contained in this document, and to prices are reserved; as are errors and omissions. Only order confirmations and technical documentation by Eaton is binding. Photos and pictures also do not warrant a specific layout or functionality. Their use in whatever form is subject to prior approval by Eaton. The same applies to trademarks (especially Eaton, Moeller, and Cutler-Hammer). The Terms and Conditions of Eaton apply, as referenced on Eaton Internet pages and Eaton order confirmations.

Eaton is a registered trademark.

All other trademarks are property of their respective owners.

Follow us on social media to get the latest product and support information.

