

# FDV LED Strips Premium Kit IP68

El nr	32 416 24
Article nr	737404
EAN	7090015379850



## Lysteknikk

Type lyskilde	SMD LED
Spenning	230VAC 50/60Hz
Watt	14,4W pr meter
Systemeffekt (W)	13,91 – 15,84W pr meter
Antall LED pr meter	160 LEDs pr meter
Effektiv lysstrøm (lm)	1950 lm
Effekt	135lm/W
Fargetemperatur	3000K
Fargegjengivelse (CRI)	Ra90
MacAdams faktor	SDCM<3
Levetid (IEC62717 Ta 25)	62000h L80B50
Lysspredning	120°

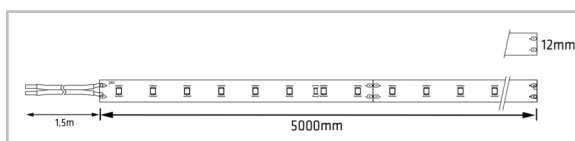
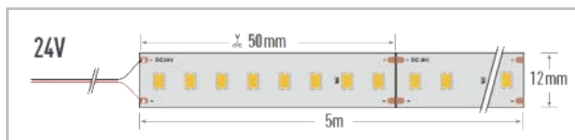

## Dimmetype

Type	Dimbar faseavsnitt
------	--------------------

## Beskyttelse

Isolasjonsklasse	Klasse II
IP-grad (armaturhus)	IP68
IP-grad (driver)	IP20

## Materialer og overflater

Armaturhus	Brass (PCB)
Farge	Hvit

## Energi og godkjenning

Energi klasse	A-A+
Godkjenning	CE, RoHS
Safety standard	EN 60598-1:2015 & EN 60598-2-21:2015, EN 62031:2008+A1:2013+A2:2015, EN 62471:2008, EN 62493:2015

## Montering/Tilkobling

Montering	Utenpåliggende
Kabling	1,5m ledning i en ender

## Dimensjoner (mm)

Lengde (L)	5000 mm
Høyde (H)	6 mm
Bredde (W)	12 mm
Vekt	0,95 kgs

## Forpakning

Eske dimensjon	295x280x90 mm
Eske Vekt	1,18 kgs
Kartong Dimensjon	610x350x490 mm
Antall/Kartong	10 stk
Kartong Vekt	13 kgs

## LED Strips Premium Kit – IP68

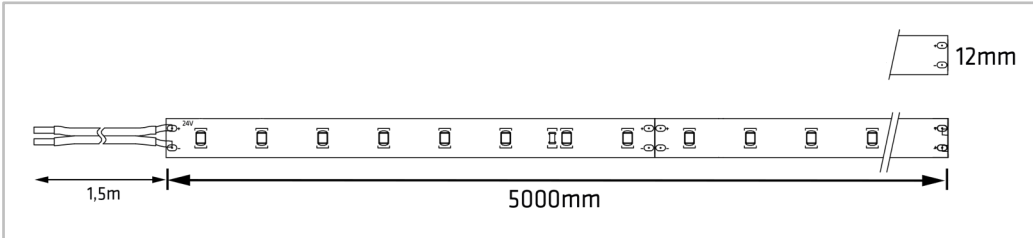

### IMPORTANT INFORMATION:

1. Please read this instruction carefully before installation and keep it for future reference.
2. Please conform to the instruction of equipment and installed by professional.
3. Make sure correct voltage applied before use and keep away from heat and vibration source.
4. The light source of this luminaire is not replaceable. When the light source reaches its end of life the whole luminaire shall be replaced.
5. The product is not suitable for any oil pollution ambient or related applications.
6. For indoor and outdoor use.

### MAIN PARAMETER:

Product	<b>737404</b>
Rated Voltage	AC 220-240V 50/60Hz
LED watt	14,4W/meter
System eff	13,91 – 15,84W/meter
Number of LED per meter	160 LEDs/meter
LED	SMD LED
LED Driver	Constant Voltage 24VDC 75W
Color Temperature	3000K
Protection	Class III (LED Strips), Class II (LED Driver)
Beam Angle	120°
IP Rated	IP68 (LED Strips), IP20 (LED Driver)
Operation Temperature	-25°C <ta<45°C
Product Size	12x6x5000mm

### INSTALLATION INSTRUCTIONS:

1. Always switch off the power supply before installation.
2. Make sure all parts are ready when open the box and prepare the installation tools the lighting needs.
3. Should be installed by qualified electricians.
4. If there is any damage on the housing or glass cover, should view it as disqualified product that cannot be used.
5. If the external flexible cable or cord of this luminaire is damaged, it shall be exclusively replaced by the manufacturer or his service agent or a similar qualified person in order to avoid a hazard.

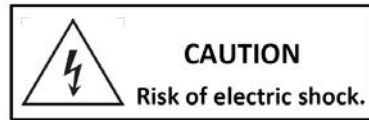
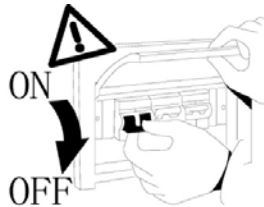

Art nr. 737404

Accessories :					
Name	Picture	Quantity	Name	Picture	Quantity
Clamp		20PCS	End cap with hole		2PCS
Glue		1PCS	End cap without hole		2PCS

### INSTALLATION STEPS:

1. Select the required position for luminaire and make sure the surface is clean. Secure LED Strips with clips using screws.

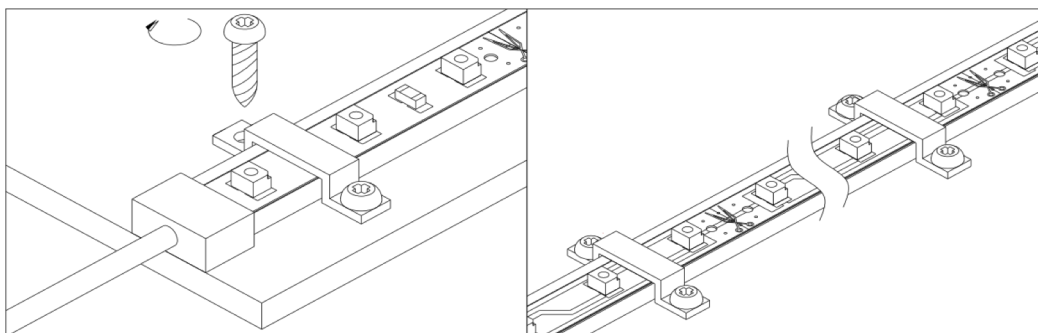

2. In case of enquiry, cut the strips along with the cutting line.

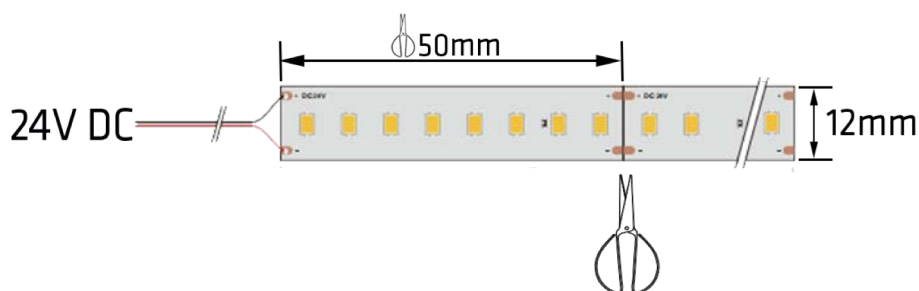

3. Connection diagram -

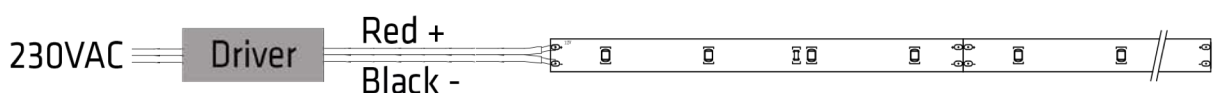

**NOTE:** LED Strips Premium Kit IP68 is with 1,5 meter cable in one end.