

Roxy

LED Surface-mounted and Pendant Luminaire



Gentle and comfortable, Roxy provides the right light for concentrated working

- Roxy convinces with a smooth and timeless design offering glare-free lighting for learning facilities or work
- Roxy will always find the right arrangement to provide its best light as surface-mounted or suspended, as single luminaire or continuous row or even as asymmetric wallwasher for whiteboards
- FLEX: Choose the lumen package directly on site via switch
- Installation by only one person possible
- Exchangeable end caps: Add value by adding a sensor or emergency option (available as accessory) or combine two luminaires



3 different types: direct, direct/indirect, asymmetrical



FLEX and DALI available



50 000 h lifetime before luminous flux is reduced to 80 % of the initial value



UGR <19: gentle, soft and glare-free lighting



Presence sensor optional



3 h emergency version optional

Ideal for...



Schools and universities



Offices and meeting rooms

Specification

- Class I electrical
- IP20
- Ambient operating temperature: -20 to +40°C (E3: 0 to +40°C)

Light source information

- Lumen packages: 4000lm (Direct), 5500lm (Direct and Direct/Indirect), 2000lm (ASYM)
- CCT 4000K
- Efficiency >120lm/W
- 50 000 hours rated life (@L80, Ta 25°C)
- CRI80
- MacAdam (initial): 4 step

Material/Finish

- Direct: Body: Extruded aluminum, Sheet steel; Diffusor: PS, UGR Sheet: PET
- Direct/Indirect: Body: Extruded aluminum, Sheet steel; Diffusor: PS, UGR Sheet: PET; Lens: PC
- Asymmetric: Body: Sheet steel; Lens: PC

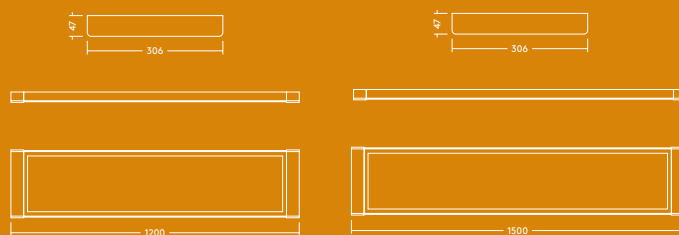

Add on to add value

Tool-free exchangeable end caps allow you to simply add on the features below:

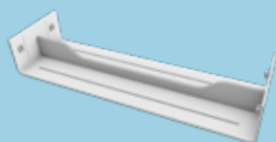

Add a connection

Connect luminaires to a continuous row.



Add safety

In case of a power failure, Roxy will support you with 3 hours emergency operation.

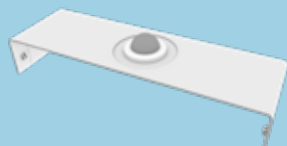

Add intelligence

Save energy costs with a presence and daylight sensor. Conveniently change your settings via dip switches directly on the sensor.

Installation/Mounting

- Suitable for ceiling mounting, (drilling template directly on packaging)
- Suitable for suspension (optional kit for direct and asymmetric luminaire)
- Wall brackets for wall mounting available

Sensor Range

at 100% sensitivity

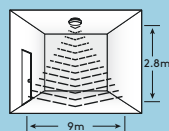

Controllability (default)

Sensitivity	50%, 100%
Time	5 sec (test mode), 5 min, 15 min, 30 min
lux	100lux, 200lux, 300lux, 400lux, 500lux, OFF

Ordering guide

Description	Wt (kg)	SAP Code
ROXY 1200 D 4000 840 FLEX	3,50	96634867
ROXY 1500 D 5500 840 FLEX	4,30	96634869
ROXY 1200 D/I 5500 840 FLEX	3,50	96634871
ROXY 1200 ASYM 2000 840	3,50	96634873
DALI		
ROXY 1200 D 4000 840 HFIX	3,50	96634868
ROXY 1500 D 5500 840 HFIX	4,30	96634870
ROXY 1200 D/I 5500 840 HFIX	3,50	96634872
ROXY 1200 ASYM 2000 840 HFIX	3,50	96634874
Accessories		
ROXY PIR PLUG&PLAY		96634876
ROXY E3 PLUG&PLAY		96634877
ROXY Connector		96634879
ROXY Suspension Kit		96634878
ROXY Wall Brackets		96634875

Portfolio Overview

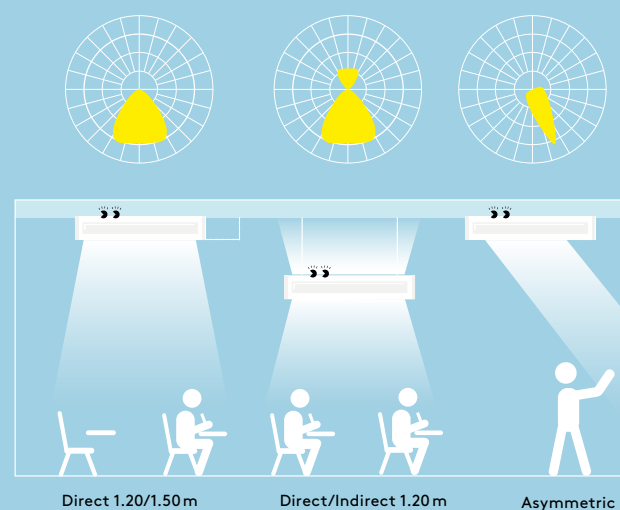

Direct 1.20/1.50m

Direct/Indirect 1.20m

Asymmetric