

## wall mounting appliance inlet - with external fixing



Product description	
BALS-Prd.-Nr	24392
EAN	4024941243926
Product group	wall mounting appliance inlet Quick-Connect
Current	16A
Number of poles	4p
Arrangement of the phases	3P+PE
Earth 'clock' position	6 h
Voltage	380 up to 415V
Frequency	50 and 60Hz

Product description	
Protection degree	IP44
Colour code	red
Colour of appliance	Housing top red, Collar red, Housing bottom grey
Connection design	screwless spring-clamp technology as cage clamp
Maximum conductor size	2,5 qmm
Cable entry	top entry M25
Height	120mm
Width	87mm
Depth	83mm
Dimension of enclosure	90x87 mm (HxW)
Material of enclosure	Polyamide
Contacts	The contact carrier is made of polyamide, The contacts are brass

Additional technical information	
	The cable entry is one at top open and one at bottom closed

Logistics data	
Weight/pcs	0.18 kg / piece
Packaging	bag
Content amount	1 ST
EAN	4024941243926

Logistics data	
Length	83 mm
Width	87 mm
Height	120 mm
Weight	0.181 kg
Volume	866.52 ccm
Packaging	carton
Content amount	10 ST
EAN	4024941967549
Length	387 mm
Width	222 mm
Height	150 mm
Weight	1.993 kg
Volume	11,029.5 ccm

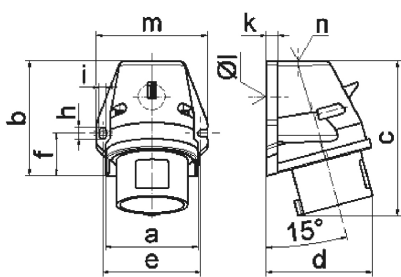

5 MB 44

Ampere	16	16	16	32	32	32
Polzahl	3	4	5	3	4	5
a	59,5	72,4	72,4	79,1	79,1	79,1
b	90,0	90,0	90,0	92,0	92,0	92,0
c	120,0	120,0	122,0	134,0	134,0	134,0
d	72,0	84,0	84,0	89,0	89,0	89,0
e	62,0	77,0	77,0	84,0	84,0	84,0
f	33,5	33,5	33,5	30,0	30,0	30,0
h	9,0	9,0	9,0	9,0	9,0	9,0
i	5,5	5,5	5,5	5,5	5,5	5,5
k	8,0	9,0	9,0	9,0	9,0	9,0
l Ø	21,0	21,0	21,0	21,0	21,0	21,0
m	72,0	87,0	87,0	94,0	94,0	94,0
n	M20	M25	M25	M25	M25	M25
Leiter mm² min	1	1	1	2,5	2,5	2,5
Leiter mm² max	2,5	2,5	2,5	6	6	6